

HOLLIS INNOVATION ACADEMY

PROJECT COMMITTEE MEETING #2

NOVEMBER 8, 2017



HABITS OF
HOLLIS

compassion
empathy
communication
self-discipline
creativity
perseverance



HOLLIS INNOVATION ACADEMY

Existing Site



Michael R. Hollis Innovation Academy



HOLLIS INNOVATION ACADEMY

Existing Photos – James P Brawley Dr





HOLLIS INNOVATION ACADEMY

Existing Photos – Griffin St





HOLLIS INNOVATION ACADEMY

Existing Photos – Interior Courtyards





HOLLIS INNOVATION ACADEMY

Existing Photos - Pool





Project Overview



- Grades: Pre K – 8
- Site Size: 5.0 acres
- Organization History: Multiple buildings. Constructed 1963 - 1970
- Status: Last renovated 2004
- Core Classrooms: +/- 41 (existing)
- Student Capacity: +/- 1,025 @ 25 students per classroom (current)
- Core Classrooms: +/- 41 (proposed)
- Student Capacity: +/- 1,025 @ 25 students per classroom (proposed)
- Approximate Size: +/- 228,355 sf (existing)
- Tentative Schedule: Phased June 2018 – June 2020



Project Outline



- Select improvements to support K-8 instructional needs
- New and additional windows
- Improved street identity
- Roof and envelope upgrades
- Door, window and hardware upgrades
- Renovated pool, pool equipment and pool structure
- Electrical, HVAC and plumbing upgrades
- Exterior and interior finish upgrades
- Data, voice, video upgrades
- Life Safety systems upgrades
- Interior and exterior signage upgrades
- CCTV, security and access control upgrades
- Furniture and casework upgrades
- Site upgrades
- Improved security and access to Main Office
- Updated HVAC, electrical and plumbing systems
- Updated low voltage, data, voice, video, life safety and security systems
- Improved landscape and hardscape



Existing Floor Plan – Level 01





**BLDG. 4010
1983
79,344 SF**

Overall Dimensions:
 64'-0" (Left)
 88'-0" (Top)
 64'-0" (Right)
 28'-0" (Bottom Left)
 398'-0" (Bottom Center)

Room Schedule and Square Footage:

- STORAGE N-205
- CLASSROOM N-204 741 SF
- SCIENCE N-201 1059 SF
- STORAGE N-203 229 SF
- COMMON AREA N-218 218 SF
- STAIR N-217 30 SF
- TEACH PLAN N-215 383 SF
- FAMILY & CONSUMER SCIENCE N-211 2660 SF
- IN-SCHOOL SUPERVISION N-226 778 SF
- TEACHING THEATER N-201 819 SF
- OFFICE N-202
- TECHNOLOGY EXPLORATION LAB N-203 3659 SF
- TEACH PLAN N-210
- STOR N-211
- WORK N-210
- BAND S-216 2442 SF
- STRING S-220 1422 SF
- CHORAL ROOM S-221 1448 SF
- ENSEMBLE RM S-217
- OFF S-218
- OFF S-219
- OFF S-222
- OFF S-223
- OFF S-224
- OFF S-225
- OFF S-226
- OFF S-227
- OFF S-228
- OFF S-229
- OFF S-230
- OFF S-231
- OFF S-232
- OFF S-233
- OFF S-234
- OFF S-235
- OFF S-236
- OFF S-237
- OFF S-238
- OFF S-239
- OFF S-240
- OFF S-241
- OFF S-242
- OFF S-243
- OFF S-244
- OFF S-245
- OFF S-246
- OFF S-247
- OFF S-248
- OFF S-249
- OFF S-250
- OFF S-251
- OFF S-252
- OFF S-253
- OFF S-254
- OFF S-255
- OFF S-256
- OFF S-257
- OFF S-258
- OFF S-259
- OFF S-260
- OFF S-261
- OFF S-262
- OFF S-263
- OFF S-264
- OFF S-265
- OFF S-266
- OFF S-267
- OFF S-268
- OFF S-269
- OFF S-270
- OFF S-271
- OFF S-272
- OFF S-273
- OFF S-274
- OFF S-275
- OFF S-276
- OFF S-277
- OFF S-278
- OFF S-279
- OFF S-280
- OFF S-281
- OFF S-282
- OFF S-283
- OFF S-284
- OFF S-285
- OFF S-286
- OFF S-287
- OFF S-288
- OFF S-289
- OFF S-290
- OFF S-291
- OFF S-292
- OFF S-293
- OFF S-294
- OFF S-295
- OFF S-296
- OFF S-297
- OFF S-298
- OFF S-299
- OFF S-300
- OFF S-301
- OFF S-302
- OFF S-303
- OFF S-304
- OFF S-305
- OFF S-306
- OFF S-307
- OFF S-308
- OFF S-309
- OFF S-310
- OFF S-311
- OFF S-312
- OFF S-313
- OFF S-314
- OFF S-315
- OFF S-316
- OFF S-317
- OFF S-318
- OFF S-319
- OFF S-320
- OFF S-321
- OFF S-322
- OFF S-323
- OFF S-324
- OFF S-325
- OFF S-326
- OFF S-327
- OFF S-328
- OFF S-329
- OFF S-330
- OFF S-331
- OFF S-332
- OFF S-333
- OFF S-334
- OFF S-335
- OFF S-336
- OFF S-337
- OFF S-338
- OFF S-339
- OFF S-340
- OFF S-341
- OFF S-342
- OFF S-343
- OFF S-344
- OFF S-345
- OFF S-346
- OFF S-347
- OFF S-348
- OFF S-349
- OFF S-350
- OFF S-351
- OFF S-352
- OFF S-353
- OFF S-354
- OFF S-355
- OFF S-356
- OFF S-357
- OFF S-358
- OFF S-359
- OFF S-360
- OFF S-361
- OFF S-362
- OFF S-363
- OFF S-364
- OFF S-365
- OFF S-366
- OFF S-367
- OFF S-368
- OFF S-369
- OFF S-370
- OFF S-371
- OFF S-372
- OFF S-373
- OFF S-374
- OFF S-375
- OFF S-376
- OFF S-377
- OFF S-378
- OFF S-379
- OFF S-380
- OFF S-381
- OFF S-382
- OFF S-383
- OFF S-384
- OFF S-385
- OFF S-386
- OFF S-387
- OFF S-388
- OFF S-389
- OFF S-390
- OFF S-391
- OFF S-392
- OFF S-393
- OFF S-394
- OFF S-395
- OFF S-396
- OFF S-397
- OFF S-398
- OFF S-399
- OFF S-400
- OFF S-401
- OFF S-402
- OFF S-403
- OFF S-404
- OFF S-405
- OFF S-406
- OFF S-407
- OFF S-408
- OFF S-409
- OFF S-410
- OFF S-411
- OFF S-412
- OFF S-413
- OFF S-414
- OFF S-415
- OFF S-416
- OFF S-417
- OFF S-418
- OFF S-419
- OFF S-420
- OFF S-421
- OFF S-422
- OFF S-423
- OFF S-424
- OFF S-425
- OFF S-426
- OFF S-427
- OFF S-428
- OFF S-429
- OFF S-430
- OFF S-431
- OFF S-432
- OFF S-433
- OFF S-434
- OFF S-435
- OFF S-436
- OFF S-437
- OFF S-438
- OFF S-439
- OFF S-440
- OFF S-441
- OFF S-442
- OFF S-443
- OFF S-444
- OFF S-445
- OFF S-446
- OFF S-447
- OFF S-448
- OFF S-449
- OFF S-450
- OFF S-451
- OFF S-452
- OFF S-453
- OFF S-454
- OFF S-455
- OFF S-456
- OFF S-457
- OFF S-458
- OFF S-459
- OFF S-460
- OFF S-461
- OFF S-462
- OFF S-463
- OFF S-464
- OFF S-465
- OFF S-466
- OFF S-467
- OFF S-468
- OFF S-469
- OFF S-470
- OFF S-471
- OFF S-472
- OFF S-473
- OFF S-474
- OFF S-475
- OFF S-476
- OFF S-477
- OFF S-478
- OFF S-479
- OFF S-480
- OFF S-481
- OFF S-482
- OFF S-483
- OFF S-484
- OFF S-485
- OFF S-486
- OFF S-487
- OFF S-488
- OFF S-489
- OFF S-490
- OFF S-491
- OFF S-492
- OFF S-493
- OFF S-494
- OFF S-495
- OFF S-496
- OFF S-497
- OFF S-498
- OFF S-499
- OFF S-500
- OFF S-501
- OFF S-502
- OFF S-503
- OFF S-504
- OFF S-505
- OFF S-506
- OFF S-507
- OFF S-508
- OFF S-509
- OFF S-510
- OFF S-511
- OFF S-512
- OFF S-513
- OFF S-514
- OFF S-515
- OFF S-516



HOLLIS INNOVATION ACADEMY

Existing Floor Plan – Level 03

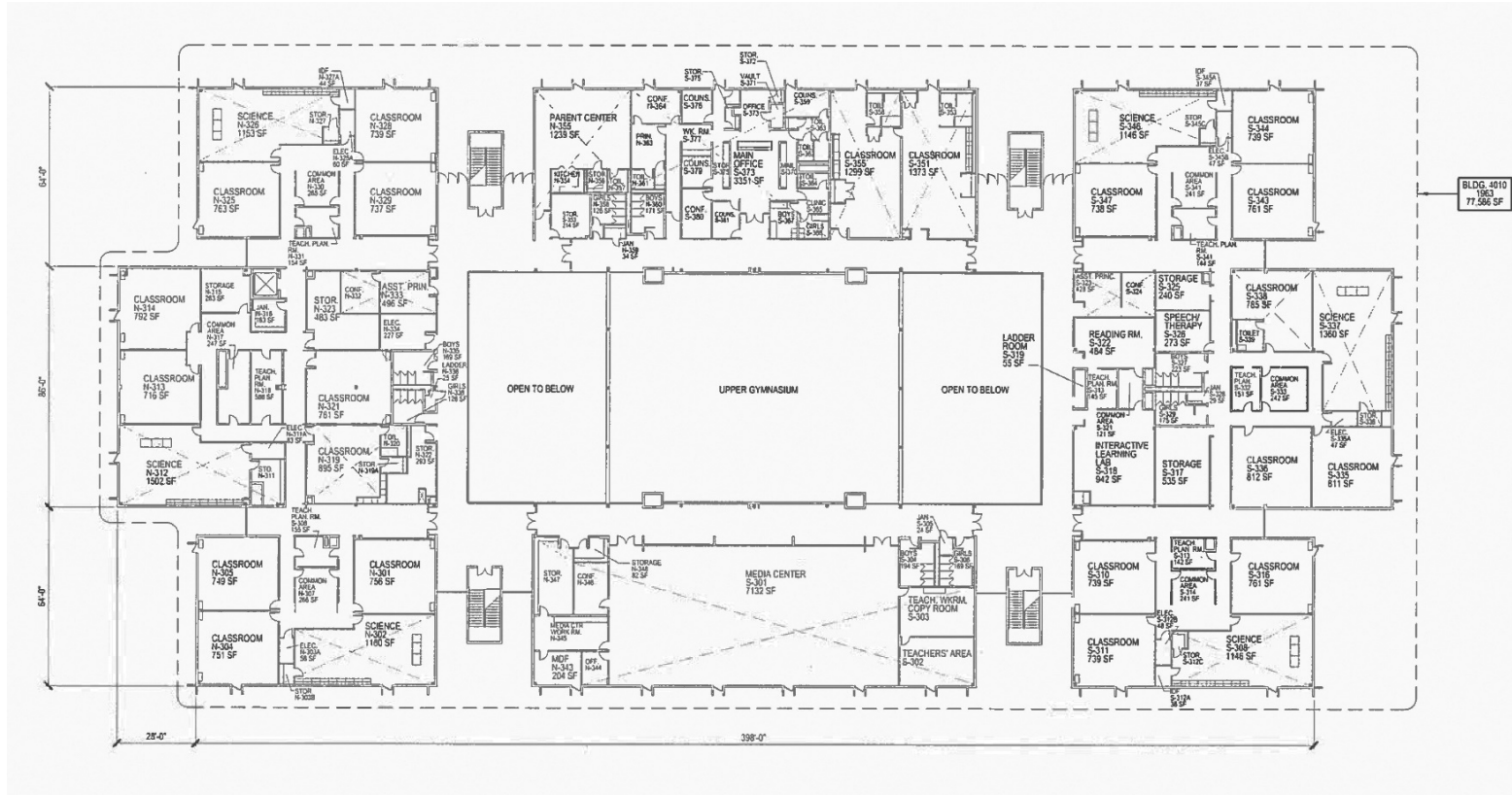



HOLLIS INNOVATION ACADEMY

New Site Plan





HOLLIS INNOVATION ACADEMY

Demo Floor Plan – Level 02

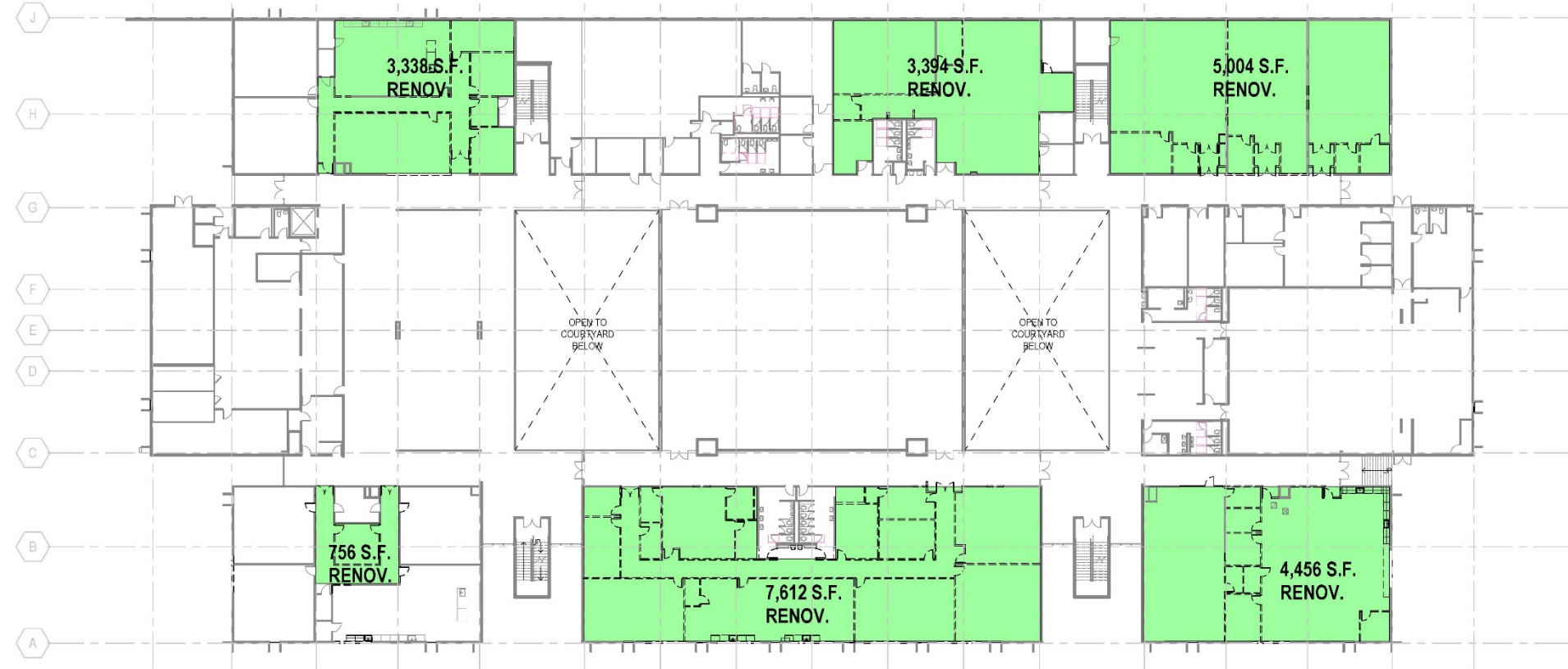

① OVERALL DEMOLITION FLOOR PLAN - LEVEL 02
1" = 20'-0"

EXISTING SECOND FLOOR AREA:
79,359 S.F.

SECOND FLOOR AREA RENOVATION:
24,555 S.F.

TOTAL RENOVATION:
34,771 S.F.



HOLLIS INNOVATION ACADEMY

Demo Floor Plan – Level 03

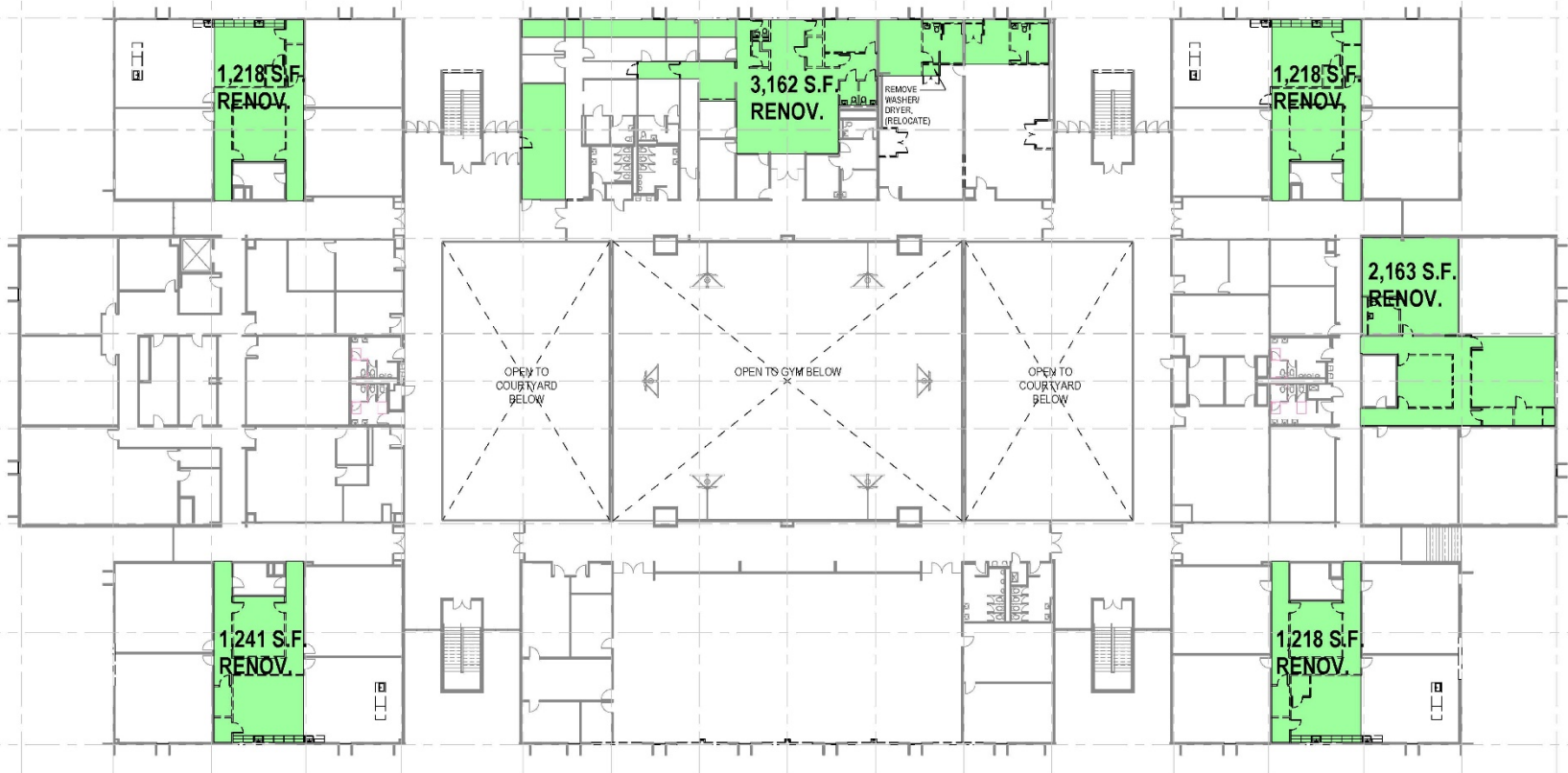

② OVERALL DEMOLITION FLOOR PLAN - LEVEL 03
1" = 20'-0"

EXISTING THIRD FLOOR AREA:
77,223 S.F.

THIRD FLOOR AREA RENOVATION:
10,216 S.F.



New Floor Plan – Level 01





ROOMS

- ADMIN
CLASSROOMS
LAB
PUBLIC
SERVICE

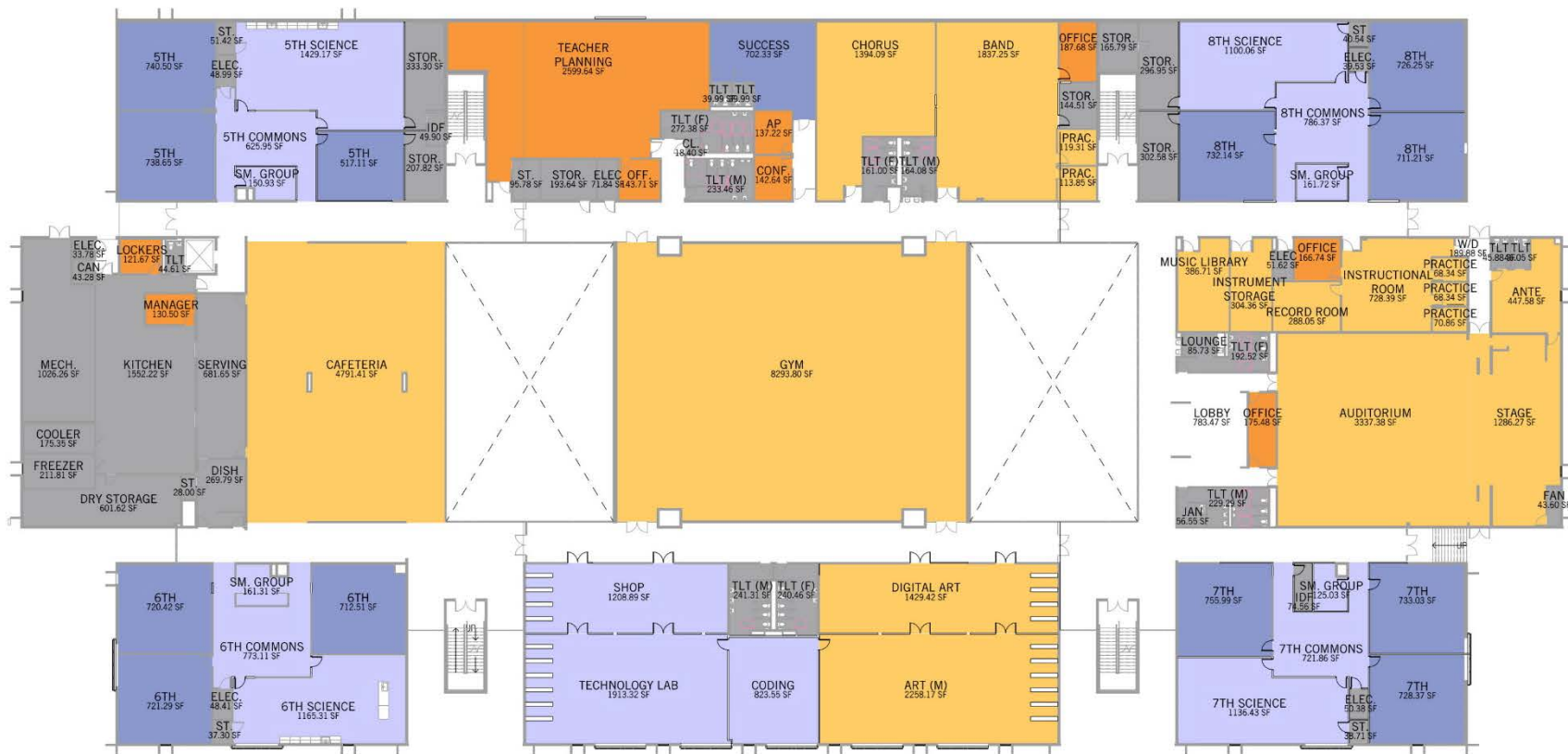



HOLLIS INNOVATION ACADEMY

New Floor Plan – Level 03 (Grades PK – 4)

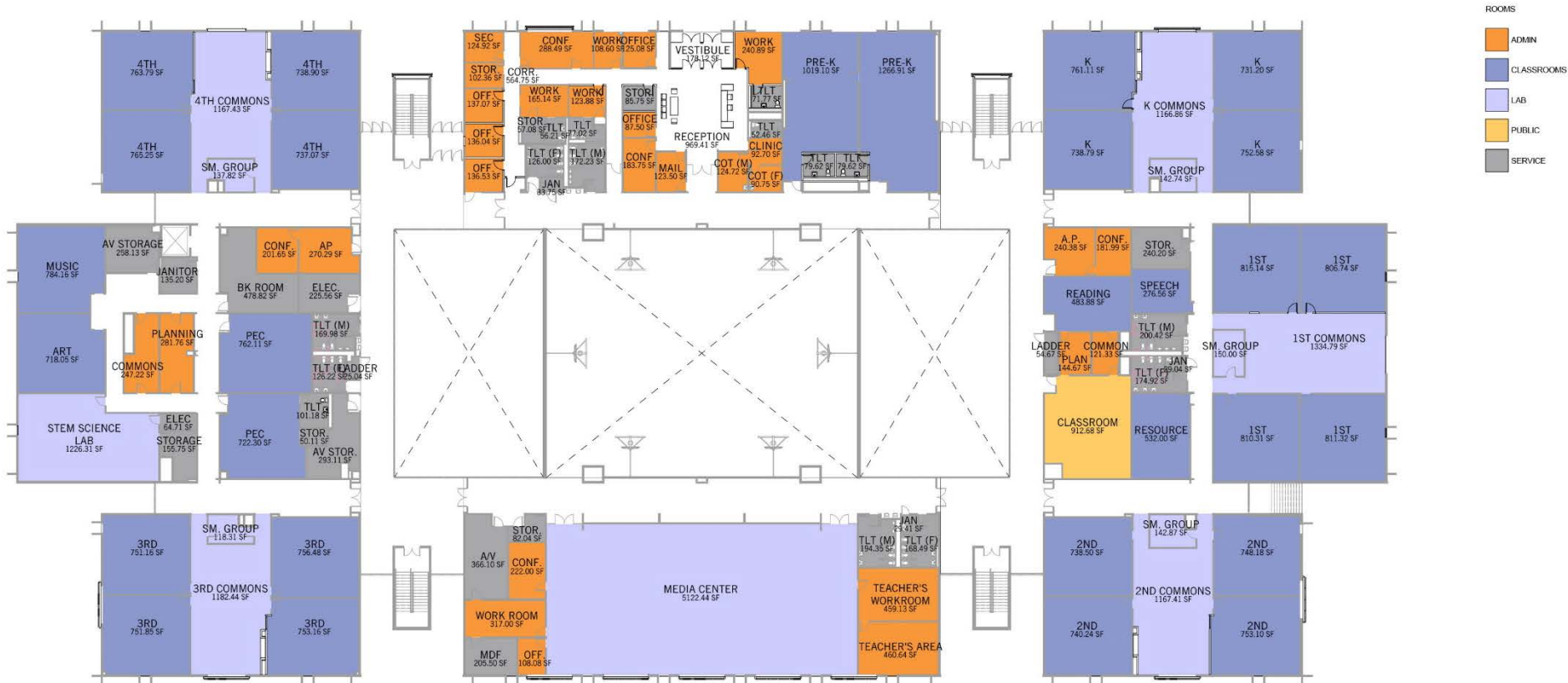



HOLLIS INNOVATION ACADEMY

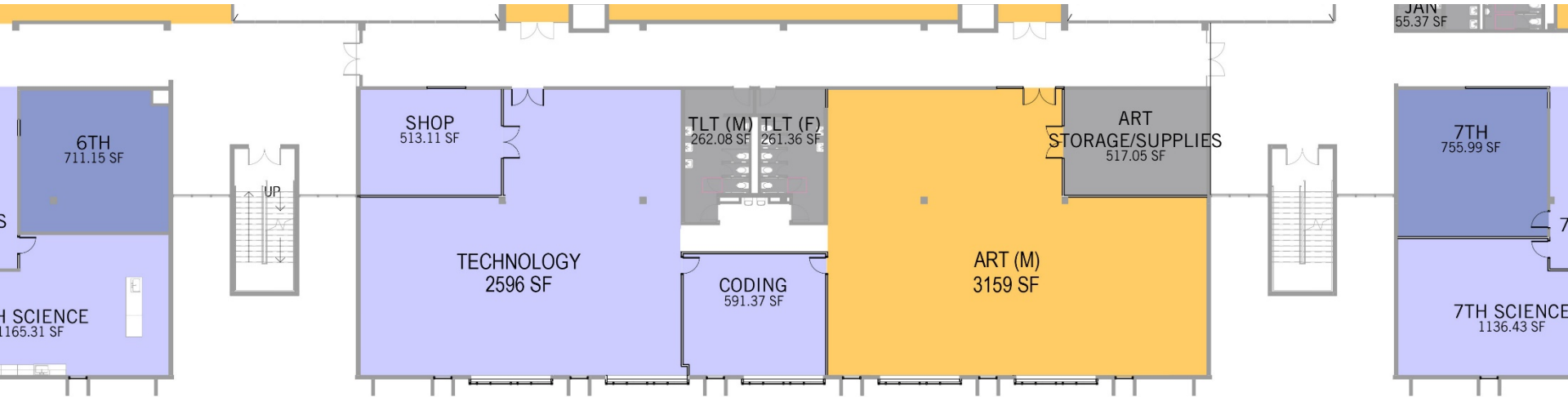



HOLLIS INNOVATION ACADEMY

Existing Photos - STEM

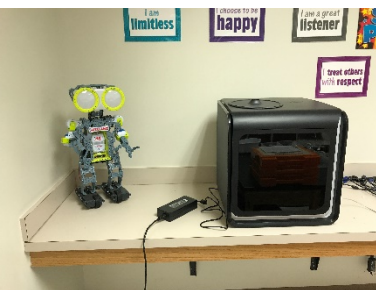



HOLLIS INNOVATION ACADEMY

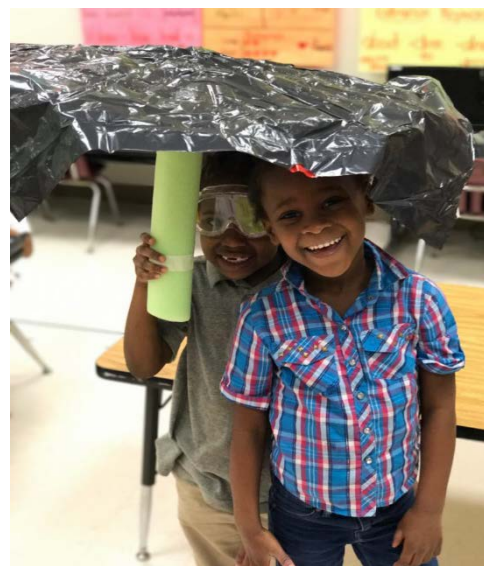
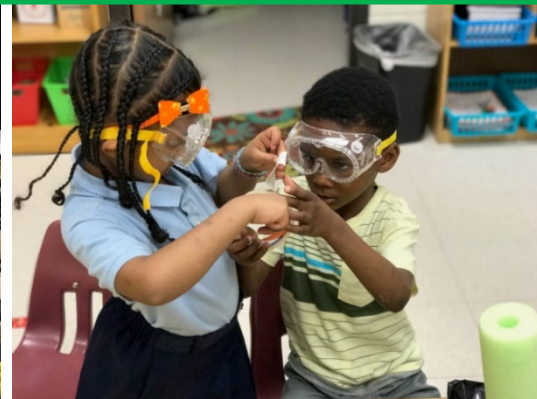
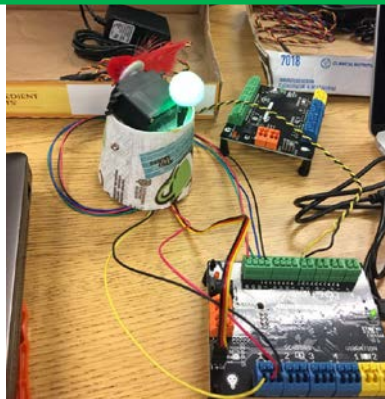



HOLLIS INNOVATION ACADEMY





HOLLIS INNOVATION ACADEMY





HOLLIS INNOVATION ACADEMY

New West Elevation





HOLLIS INNOVATION ACADEMY

New West Elevation





HOLLIS INNOVATION ACADEMY

New East Elevation



Q & A
THANK YOU



HOLLIS INNOVATION ACADEMY

